

DC/17/0301: Cars accessing/exiting the drive of the proposed house

The applicant has produced a series of four carefully selected diagrams (scenarios) that seek to minimise the difficulties and safety issues associated with car accessing and exiting the proposed house. The Parish Council's comments in italics on these scenarios and on some additional scenarios clearly illustrate the difficulties and hazards that cannot be overcome.

The applicant's figure opposite shows car 1 accessing the site when no other car is parked.

Car 1 has to use all of the opposite side of the carriageway to make the turn into the drive. This is unacceptable.

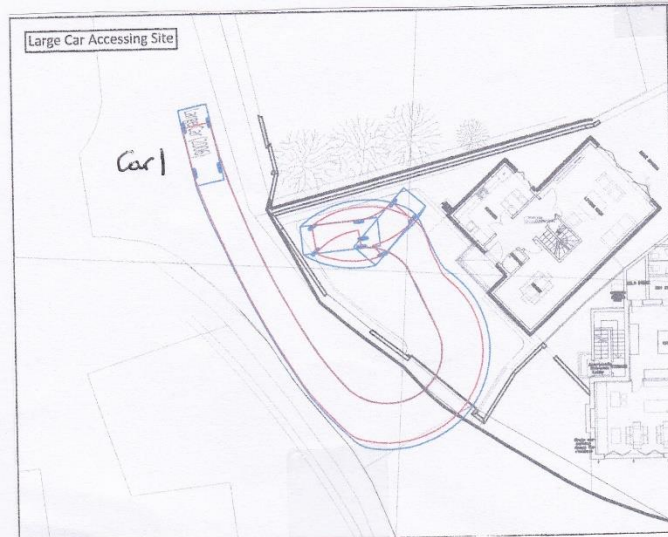

The applicant has failed to show car 1 accessing the site when car 2 is parked. Car 1 is unable to make the tight turn to get past car 2 to the parking place as shown opposite. This is unacceptable

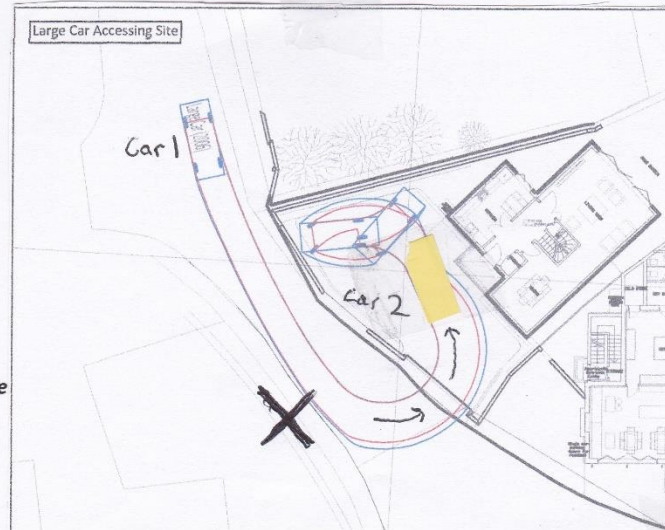

DC/17/0301

The applicant's figure opposite shows a large car 1 exiting the site in a southerly direction towards the A281 when car 2 is parked in the drive.

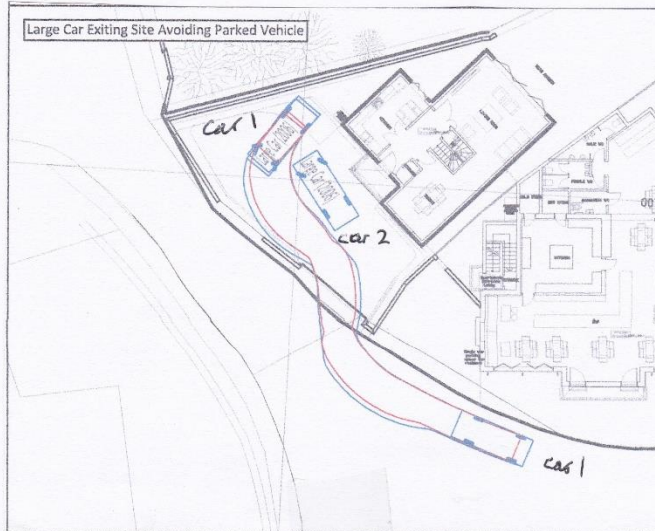

The applicant has failed to show car 1 exiting in a northerly direction towards Mannings Heath Village simply because the drive is not wide enough for it to make the turn. It is not acceptable to be unable to turn towards the Village.

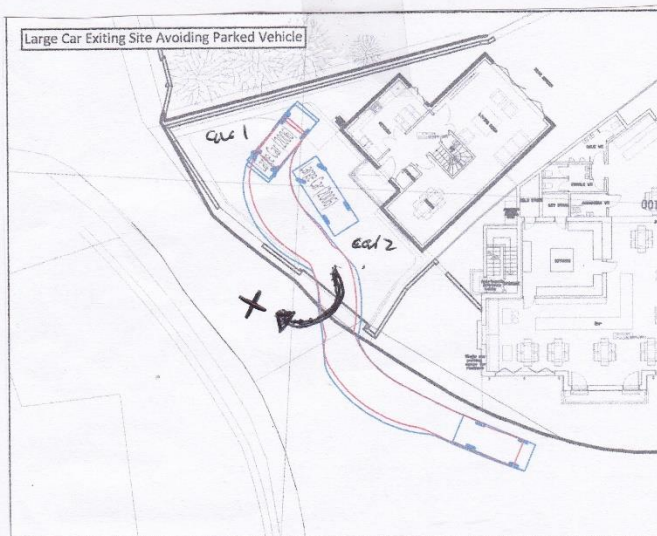

DC/17/0301

The applicant's figure opposite shows car 2 having to do a multipoint turn in order to exit the site in a southerly direction towards the A281 when car 1 is parked in the drive. ***Given the narrowness of the drive at the turning point it is likely that even more manoeuvres than shown would be required to in a forward direction exit. This amount of manoeuvring is unlikely to happen in practice.***

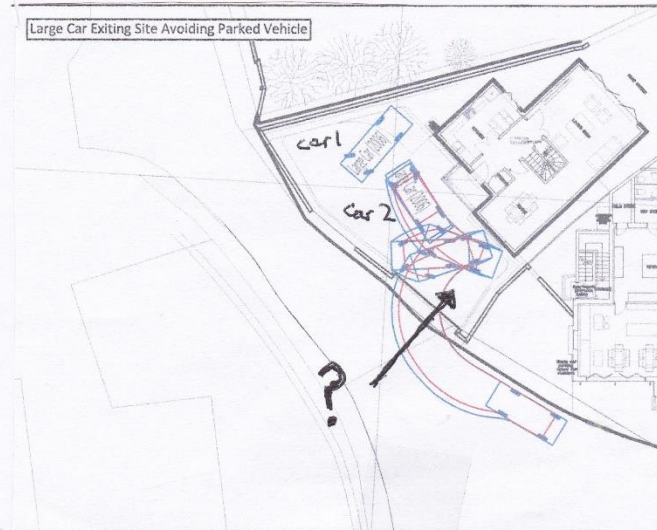

The applicant has failed to show car 2 exiting in a northerly direction towards Mannings Heath Village. Considerably more manoeuvring would be needed to get car 2 in a position where it could turn right towards the Village. It is unlikely that car owners would be prepared to do so. They would back out into Pound Road close to a bend. This is unacceptable.

